



JAMES
ANDERSON



TO LET

Sheen Lane, East Sheen, SW14

£1,375 Per Month

Per Month

A one bedroom apartment situated within moments of Mortlake station and close to all amenities that East Sheen and Mortlake have to offer. The property comprises one double bedroom, modern kitchen and reception room. The open spaces of Richmond Park and Mortlake Green are nearby and the River Thames is within easy reach.



One Double Bedroom



One Bathroom



Unfurnished



Modern Fitted Kitchen



EPC D | Council Tax C | Holding Deposit £317.30



Mortlake Train Station



Thomson House Primary School



Central Location



Neutral Throughout



Deposit £1586.53 | Minimum Term 6 Months



OPEN 7 DAYS A WEEK • Weekdays until 9pm • Weekends until 5pm

0208 876 6611

Sheen Lane, London, SW14

APPROX. GROSS INTERNAL FLOOR AREA 556 SQ FT 51.6 SQ METRES

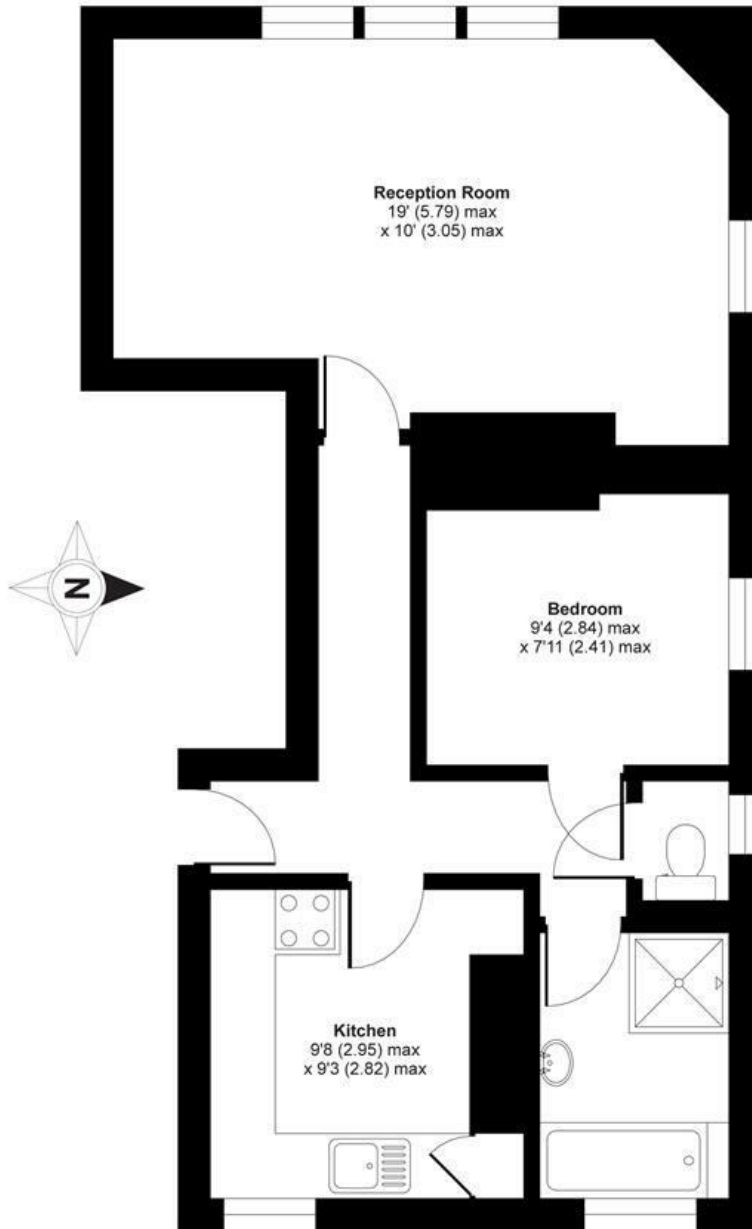

FIRST FLOOR

Whilst every attempt has been made to ensure the accuracy of the floor plan contained here, measurements of doors, windows and rooms are approximate and no responsibility is taken for any error, omission or misstatement. These plans are for representation purposes only as defined by RICS Code of Measuring Practice and should be used as such by any prospective purchaser. Specifically no guarantee is given on the total square footage of the property if quoted on this plan. Any figure given is for initial guidance only and should not be relied on as a basis of valuation.

Copyright nichecom.co.uk 2019 Produced for James Anderson REF : 524577

Energy Efficiency Rating		Current	Potential
<i>Very energy efficient - lower running costs</i>			
(92 plus) A			75
(81-91) B			
(69-80) C			
(55-68) D		60	
(39-54) E			
(21-38) F			
(1-20) G			
<i>Not energy efficient - higher running costs</i>			
England & Wales		EU Directive 2002/91/EC	

Environmental Impact (CO ₂) Rating		Current	Potential
<i>Very environmentally friendly - lower CO2 emissions</i>			
(92 plus) A			75
(81-91) B			
(69-80) C			
(55-68) D		55	
(39-54) E			
(21-38) F			
(1-20) G			
<i>Not environmentally friendly - higher CO2 emissions</i>			
England & Wales		EU Directive 2002/91/EC	

