



JAMES
ANDERSON



TO LET

Elm Bank Mansions, Barnes, SW13

£1,500 Per Month

Per Month

This apartment is situated on the ground floor of a period mansion block, opposite the River Thames. There is a spacious entrance hall which leads to the living room which has large sash windows, and a fully fitted kitchen. There is a separate bathroom and w/c, and a large double bedroom. The apartment has been recently carpeted and is available on a part furnished or unfurnished basis. Barnes Bridge Station and the high street are a short walk away.



One Large Bedroom



Bathroom



Bright Reception



Spacious Kitchen



EPC Rating D/Council Tax D/Deposit £1,730.77



Barnes Bridge Station



Excellent Local Schools



Close to the River Thames



Unfurnished or Part Furnished



Holding Deposit £346.15 / Minimum Term 12 Months



OPEN 7 DAYS A WEEK • Weekdays until 9pm • Weekends until 5pm

0208 878 8688

Elm Bank Mansions, London, SW13

APPROX. GROSS INTERNAL FLOOR AREA 544 SQ FT 50.5 SQ METRES

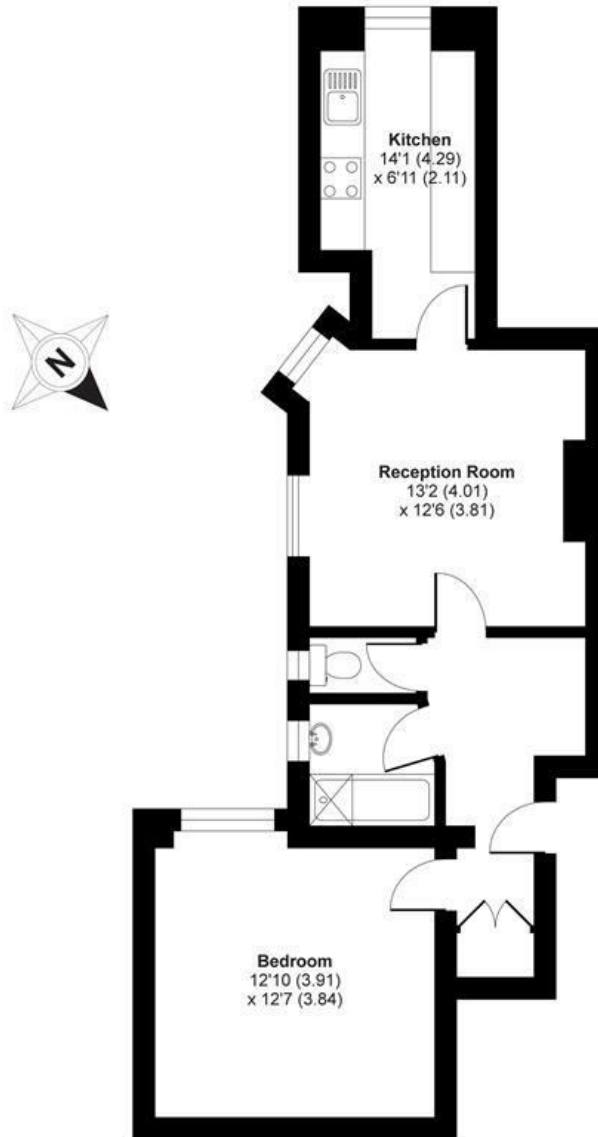

GROUND FLOOR

Whilst every attempt has been made to ensure the accuracy of the floor plan contained here, measurements of doors, windows and rooms are approximate and no responsibility is taken for any error, omission or misstatement. These plans are for representation purposes only as defined by RICS Code of Measuring Practice and should be used as such by any prospective purchaser. Specifically no guarantee is given on the total square footage of the property if quoted on this plan. Any figure given is for initial guidance only and should not be relied on as a basis of valuation.

Copyright nichecom.co.uk 2019 Produced for James Anderson REF : 512368

