



**JAMES  
ANDERSON**



## FOR SALE

**£750,000**

### Courtlands, Sheen Road, Richmond, TW10

Buckingham House on the prestigious and sought after Courtlands residential development, is a stunning and beautifully presented 100 m2 three bedroom second floor apartment with two balconies. There are two generously sized double bedrooms, one with an en suite bathroom and a third smaller double bedroom/study. A spacious dining area leads to a large and bright reception room and a very well quipped contemporary kitchen. In addition to the en suite, there is also a family bathroom. This stylish apartment also benefits from plenty of storage space and provides easy lift access. There is also off street parking. This property is ideally located close to Richmond and all the amenities of East Sheen with excellent transport links close by including North Sheen Station and Richmond.



Three bedrooms



Two Bathrooms



Reception and Dining room



Kitchen



EPC rating C



North Sheen or Richmond Station



Outstanding Schools



Close to Richmond Park



No Onward Chain



Communal Gardens



# Buckingham House

Approximate Gross Internal Area = 100.2 sq m / 1078 sq ft

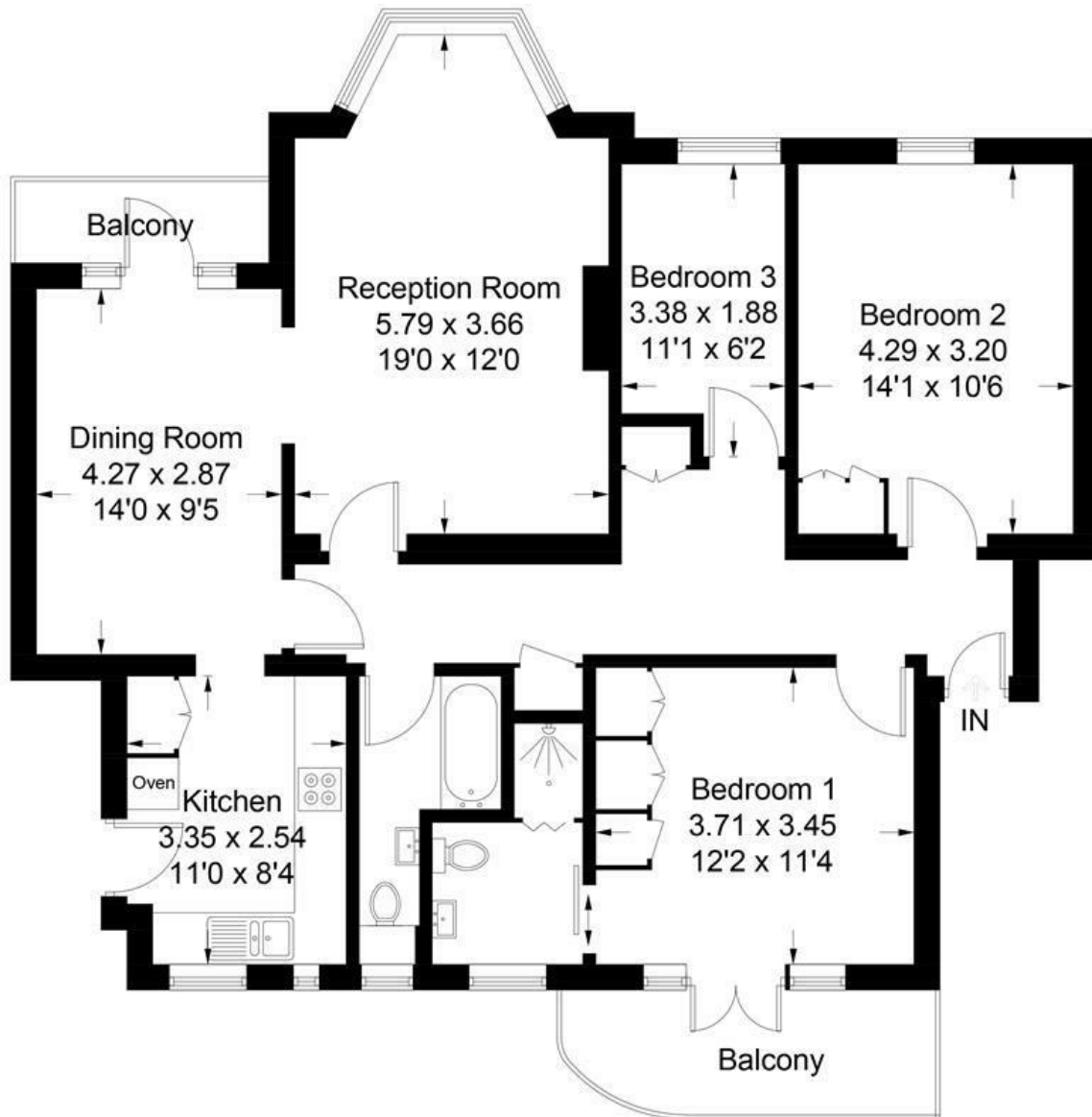

## Second Floor

Illustration for identification purposes only, measurements are approximate, not to scale. FloorplansUsketch.com © 2017 (ID399668)

