



**JAMES  
ANDERSON**



## TO LET

Cowley Road, Mortlake, SW14

**£2,250 Per Month**

Per Month

Spacious three bedroom maisonette located on a popular tree lined road in Mortlake. The property comprises a large reception room, two double bedrooms, one with built in wardrobes and one single bedroom/study. The property offers a modern fitted kitchen with dining area, modern bathroom suite and a private decking area leading down to a shared garden. Cowley Road is conveniently situated within a few minutes walk of Mortlake Station and the shops/cafes of White Hart Lane.



Three Bedrooms



Modern Bathroom



Bright Reception



Large Kitchen/Diner



Epc Rating D



Close to Barnes Bridge



Thomson House School



Close to the River



Shared Garden



Upper Maisonette



OPEN 7 DAYS A WEEK • Weekdays until 9pm • Weekends until 5pm

0208 878 8688

# Cowley Road, London, SW14

APPROX. GROSS INTERNAL FLOOR AREA 829 SQ FT 77 SQ METRES

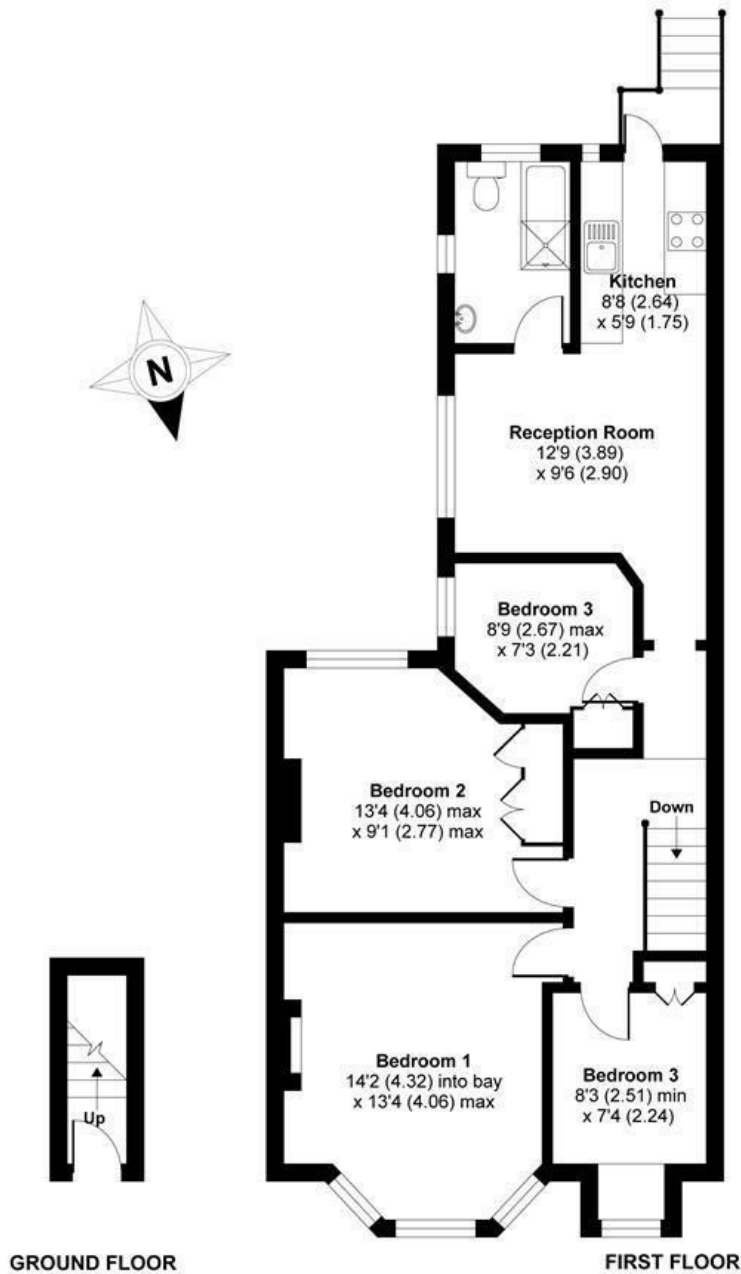

Whilst every attempt has been made to ensure the accuracy of the floor plan contained here, measurements of doors, windows and rooms are approximate and no responsibility is taken for any error, omission or misstatement. These plans are for representation purposes only as defined by RICS Code of Measuring Practice and should be used as such by any prospective purchaser. Specifically no guarantee is given on the total square footage of the property if quoted on this plan. Any figure given is for initial guidance only and should not be relied on as a basis of valuation.

Copyright nichecom.co.uk 2018 Produced for James Anderson REF : 286279

Energy Efficiency Rating		Current	Potential
Very energy efficient - lower running costs			
(92 plus) <b>A</b>			
(81-91) <b>B</b>			
(69-80) <b>C</b>			
(55-68) <b>D</b>		55	65
(39-54) <b>E</b>			
(21-38) <b>F</b>			
(1-20) <b>G</b>			
Not energy efficient - higher running costs			
<b>England &amp; Wales</b>	EU Directive 2002/91/EC		

Environmental Impact (CO <sub>2</sub> ) Rating		Current	Potential
Very environmentally friendly - lower CO <sub>2</sub> emissions			
(92 plus) <b>A</b>			
(81-91) <b>B</b>			
(69-80) <b>C</b>			
(55-68) <b>D</b>		48	61
(39-54) <b>E</b>			
(21-38) <b>F</b>			
(1-20) <b>G</b>			
Not environmentally friendly - higher CO <sub>2</sub> emissions			
<b>England &amp; Wales</b>	EU Directive 2002/91/EC		

