



JAMES
ANDERSON



TO LET





Sheen Lane, East Sheen, SW14

£1,700 Per Month

Per Month

SHORT LET - Character cottage situated in the heart of East Sheen, moments from Mortlake station. This property offers a large reception with doors out to the private garden, fully fitted kitchen, one spacious double bedroom and a three-piece bathroom. Sheen Lane is located a short walk from all of the amenities in East Sheen including Waitrose and several pubs/cafes/shops. The property is offered fully furnished on a short term basis.

-  One Bedroom Cottage
-  One Bathroom
-  Large Reception
-  Fully Fitted Kitchen
-  EPC Rating D

-  Mortlake Station
-  Excellent Local Schools
-  Central East Sheen
-  Private Garden
-  Short Let



OPEN 7 DAYS A WEEK • Weekdays until 9pm • Weekends until 5pm

0208 876 6611

Sheen Lane

Approximate Gross Internal Area = 692 sq ft / 64.4 sq m

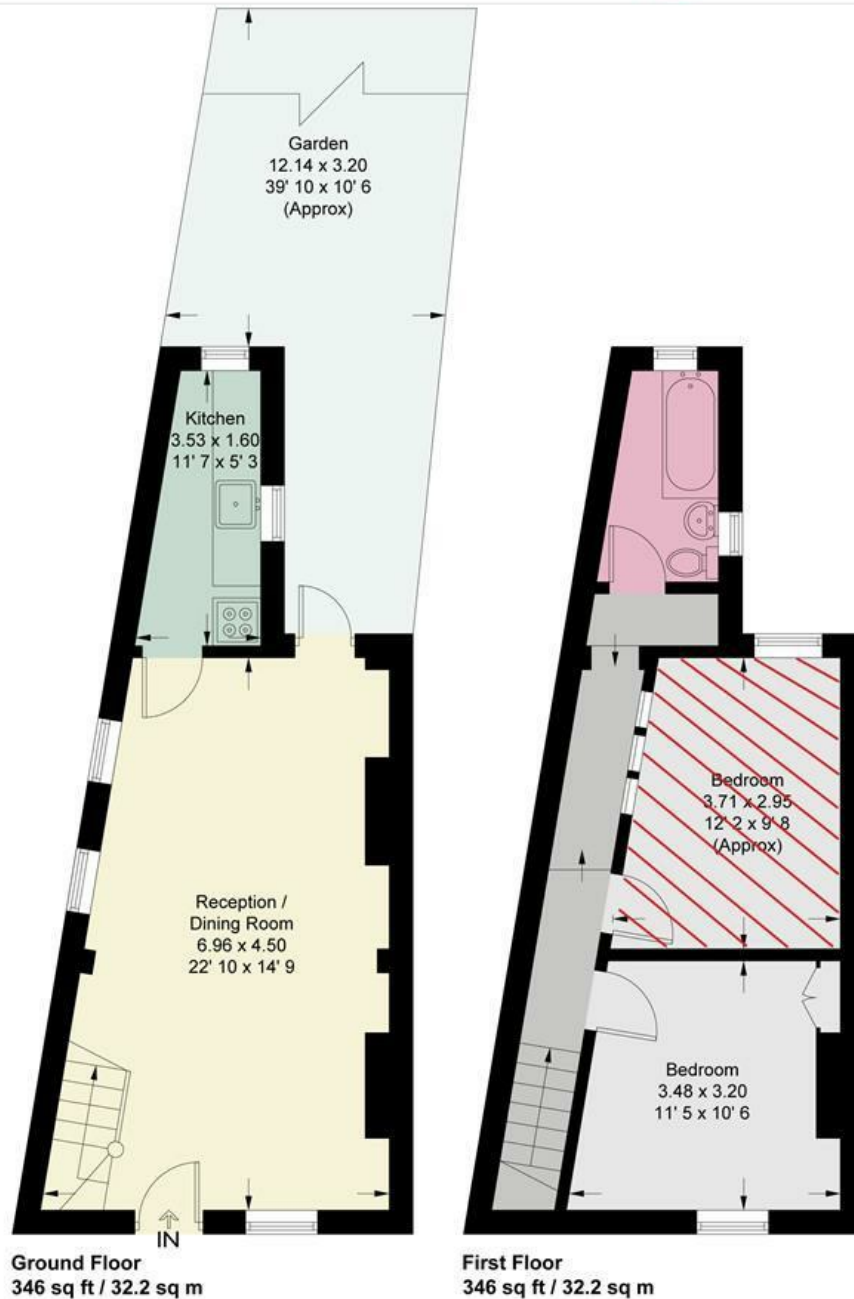

This plan is not to scale and must be used as layout guidance only. All measurements and areas are approximate and should not be relied upon to provide accurate information. This plan must not be relied upon when making property valuations, design considerations or any other such relevant decisions. We accept no responsibility or liability (whether in contract, tort or otherwise) in relation to any loss whatsoever arising from or in connection with any use of this plan or the adequacy, accuracy or completeness of it or any information within it.



Energy Efficiency Rating		Current	Potential
Very energy efficient - lower running costs			
(92 plus) A			82
(81-91) B			
(69-80) C			
(55-68) D			
(39-54) E		58	
(21-38) F			
(1-20) G			
Not energy efficient - higher running costs			
England & Wales		EU Directive 2002/91/EC	

Environmental Impact (CO ₂) Rating		Current	Potential
Very environmentally friendly - lower CO ₂ emissions			
(92 plus) A			82
(81-91) B			
(69-80) C			
(55-68) D			
(39-54) E			
(21-38) F			
(1-20) G			
Not environmentally friendly - higher CO ₂ emissions			
England & Wales		EU Directive 2002/91/EC	

