



JAMES
ANDERSON



FOR SALE

£600,000

Lower Richmond Road, Mortlake, SW14

A stunning three bedroom ground floor maisonette with a private south facing garden. The property is beautifully presented throughout and offers accommodation arranged to provide two double bedrooms, one with en-suite shower room, a third bedroom/study, one family bathroom and a large open plan kitchen and living area at the rear of the property which opens out onto a private garden. There is ample storage throughout and the property also benefits from a share of the freehold. Excellent public transport links are available with Mortlake station a short walk away and local bus services providing access into Richmond and Hammersmith with their underground networks.



Three Bedrooms



Two Bathrooms



Open Plan Reception / Living Area



Fully Equipped Kitchen



EPC Rating



Mortlake Station



Excellent Local Schools Nearby



East Sheen / Richmond Borders



Private South Facing Garden



Share Of Freehold



OPEN 7 DAYS A WEEK • Weekdays until 9pm • Weekends until 5pm

020 8876 6611



 = Reduced headroom below 1.5m / 5'0"

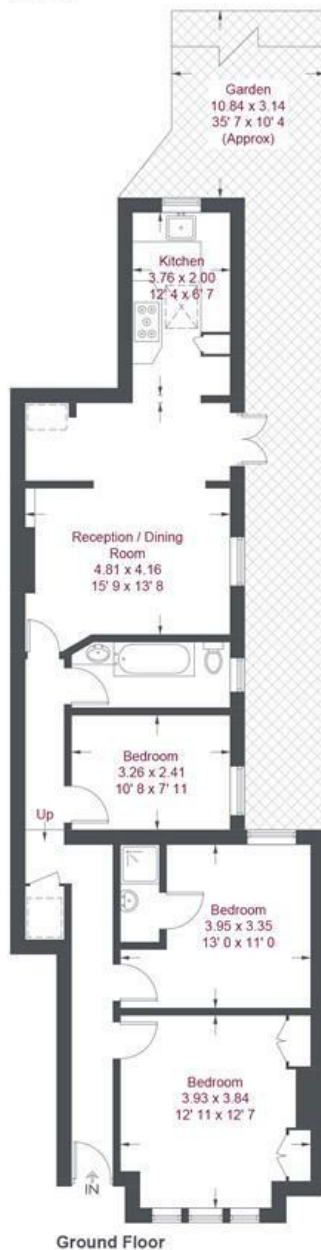

Ground Floor

Lower Richmond Road

Approximate Gross Internal Area = 911 sq ft / 84.7 sq m

(Excluding Reduced Headroom)

Reduced Headroom = 11 sq ft / 1 sq m

Total = 922 sq ft / 85.7 sq m

Not to scale, for guidance only and must not be relied upon as a statement of fact

All measurements and areas are approximate only and have been prepared in accordance with the current edition of the RICS Code of Measuring Practice

