



JAMES  
ANDERSON

Borneo Street  
London SW15  
Guide Price £835,000



## Borneo Street London SW15

A beautifully presented, high specification two-bedroom garden flat located on the highly regarded Borneo Street in the heart of West Putney. Occupying the ground floor of this attractive Victorian purpose-built property, the home benefits from its own private entrance, a delightful garden and, being end of terrace, enjoys excellent natural light throughout.

The accommodation is well balanced and stylishly presented. To the front of the property is an elegant reception room with a charming bay window and bespoke built-in cupboards either side of the fireplace, creating a welcoming and comfortable living space.

The principal bedroom is positioned to the rear of the property and enjoys a peaceful outlook over the garden, complemented by a range of fitted wardrobes providing excellent storage. The second bedroom also features built-in wardrobes and offers flexibility as either a guest bedroom or an ideal home office.

A particular highlight of the property is the impressive kitchen/breakfast room extending to over 23 ft, designed as a wonderful entertaining space with a fully fitted kitchen, generous preparation space and ample room for a large dining table. The room opens directly onto the private patio garden, creating a seamless connection between indoor and outdoor living.

The garden faces east and also benefits from a pleasant southerly aspect from the side, allowing for good natural sunlight throughout the day.

Borneo Street is a highly regarded residential road in West Putney, ideally located for the excellent amenities of Putney High Street, the green open spaces of Wandsworth Park and the River Thames, as well as convenient transport links including Putney mainline station and East Putney Underground. The area is also well known for its strong sense of community, excellent local cafés, restaurants and highly regarded schools nearby.

Tenure - Share Of Freehold  
EPC - Grade C





PICASSO

THE PIGS  
MUSÉE D'ORSAY













# BORNEO STREET, SW15

Approx. gross internal area 888 Sq Ft. / 82.5 Sq M

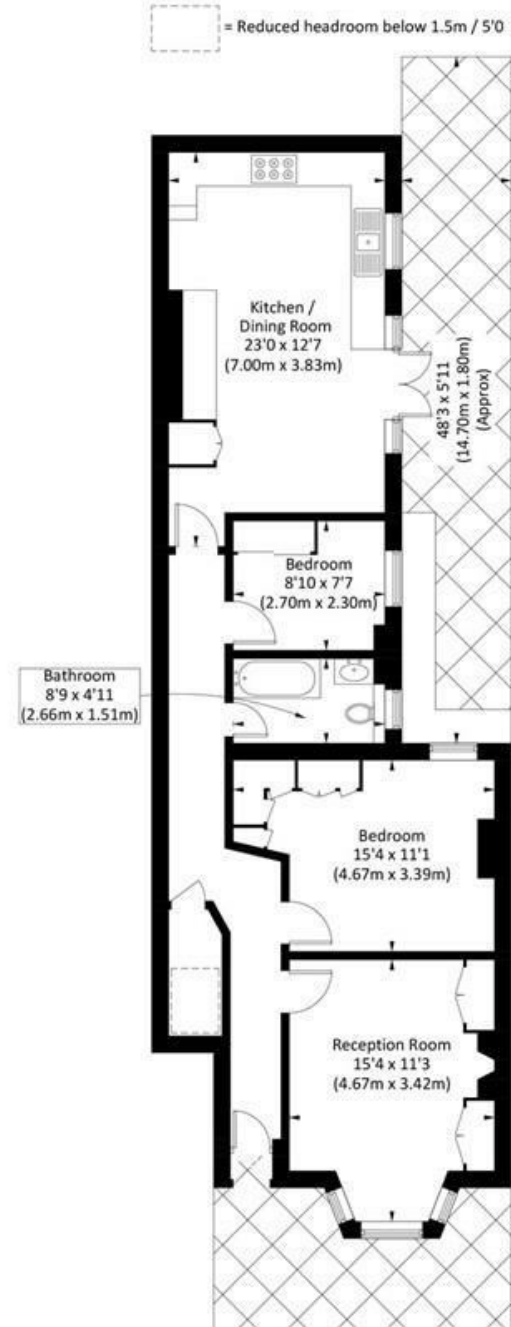

JAMES  
ANDERSON

Illustration for identification purposes only, measurements are approximate, not to scale. Fourlabs.co © 2025 (ID1240920)



78 Lower Richmond Road  
Putney  
SW15 1LL

020 8788 6611  
sales@japutney.co.uk  
www.jamesanderson.co.uk

