



JAMES
ANDERSON

Clydesdale Close
Isleworth TW7















**JAMES
ANDERSON**

Clydesdale Close Isleworth TW7

Refurbished mid-terrace house located on Clydesdale Close, a quiet cul-de-sac in Isleworth. This property features a well-proportioned reception room with wooden floors and patio doors out to the private garden, a modern kitchen with new appliances, and a downstairs WC. Upstairs, there are two spacious double bedrooms with new carpets, one of which is equipped with built-in wardrobes, offering ample storage space and convenience, and a contemporary bathroom. The property also benefits from off-street parking for one car. Clydesdale Close is situated in a friendly neighbourhood, with local amenities and transport links within easy reach. Isleworth Station is 0.6 miles from the property.

-  Two Bedrooms
-  One Bathroom | One WC
-  Spacious Reception
-  Modern Kitchen
-  EPC C | Council Tax Band D
-  Isleworth Station
-  Saint Mary's Catholic Primary School
-  Close to Syon Park
-  Private Garden
-  Deposit £2423.07 | Holding Deposit £484.61







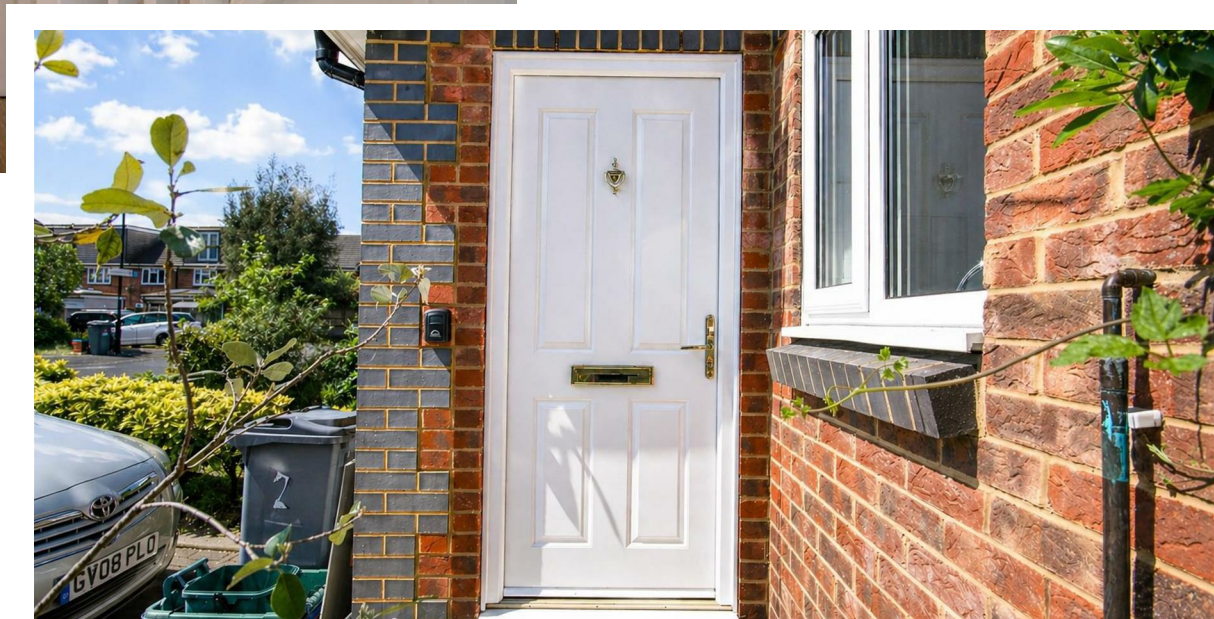
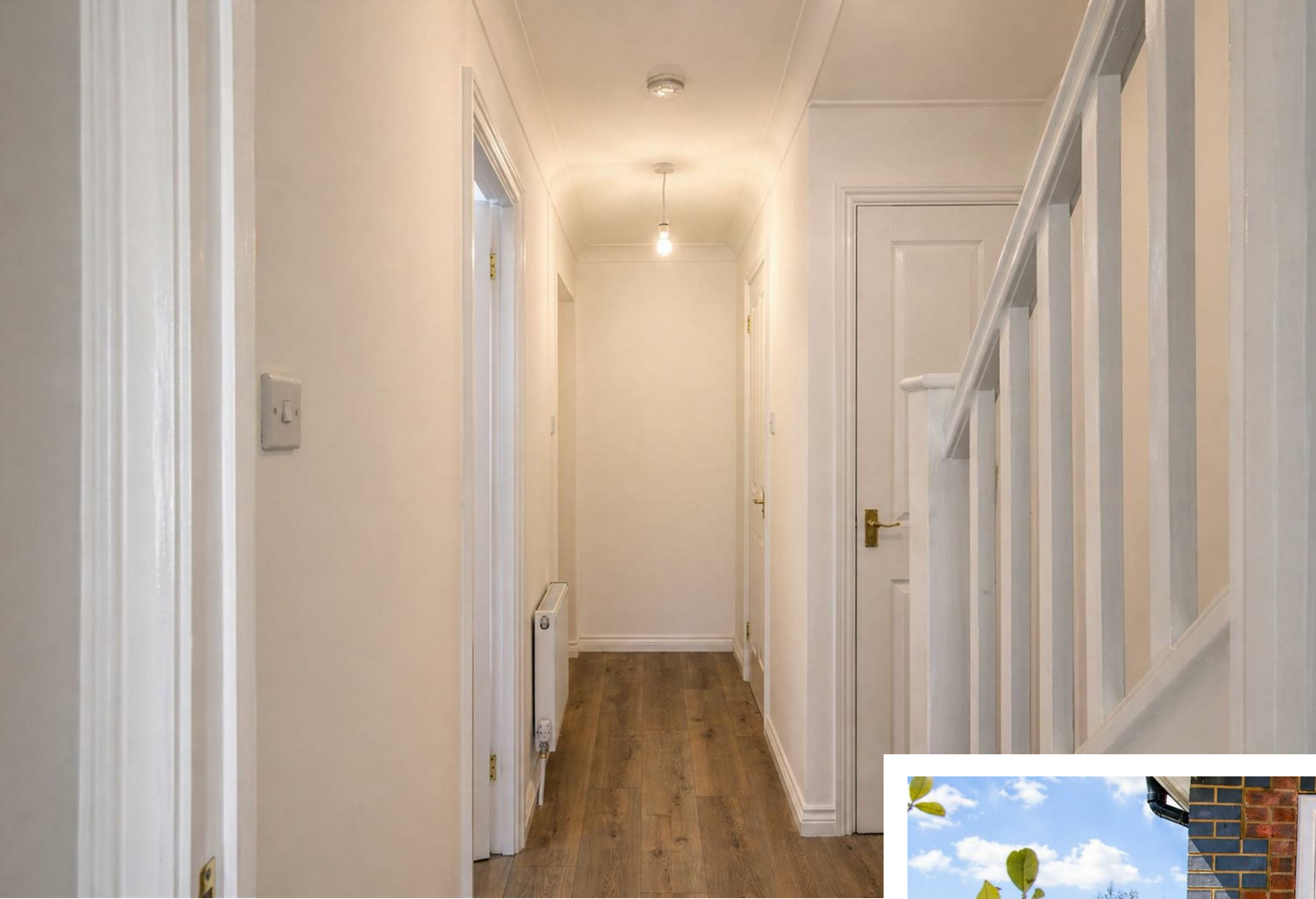







Clydesdale Close



Approx Gross Internal Area
57 sq m / 616 sq ft

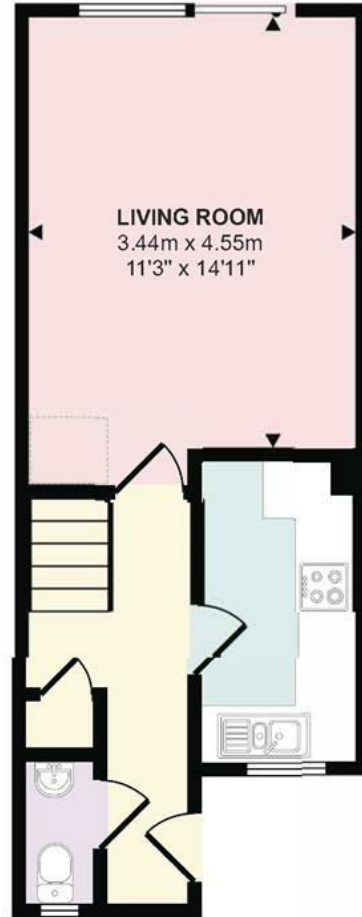

Ground Floor
Approx 30 sq m / 319 sq ft

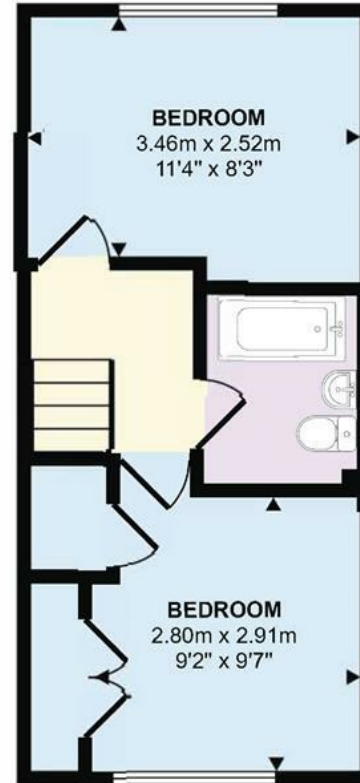

First Floor
Approx 28 sq m / 297 sq ft

Denotes head height below 1.5m

This floorplan is only for illustrative purposes and is not to scale. Measurements of rooms, doors, windows, and any items are approximate and no responsibility is taken for any error, omission or mis-statement. Icons of items such as bathroom suites are representations only and may not look like the real items. Made with Made Snappy 360.

363 Upper Richmond Road West
East Sheen
SW14 7NX

0208 876 6611
eastsheen2@jamesanderson.co.uk
www.jamesanderson.co.uk

