



JAMES  
ANDERSON



## TO LET

Upper Richmond Road, London, SW15

**£1,700 Per Month**

Per Month

Newly decorated one double bedroom ground floor flat rent Harwood Court just off the Upper Richmond Road.

There are local shops, cafes and a swimming pool/fitness center close by. The Upper Richmond Road is well served by buses and East Putney tube station is around four stops away.



One Double Bedroom



One Bathroom



Open Plan Reception



Modern Kitchen



EPC C / Council Tax B / Holding Deposit £392.30



Putney Train Station



Putney High



Rent Includes Heating



Newly Decorated



Minimum Term 12 Months / Deposit £1961.53



OPEN 7 DAYS A WEEK • Weekdays until 9pm • Weekends until 5pm

**0208 785 4400**

Harwood Court

Approximate Gross Internal Area = 372 sq ft / 34.6 sq m

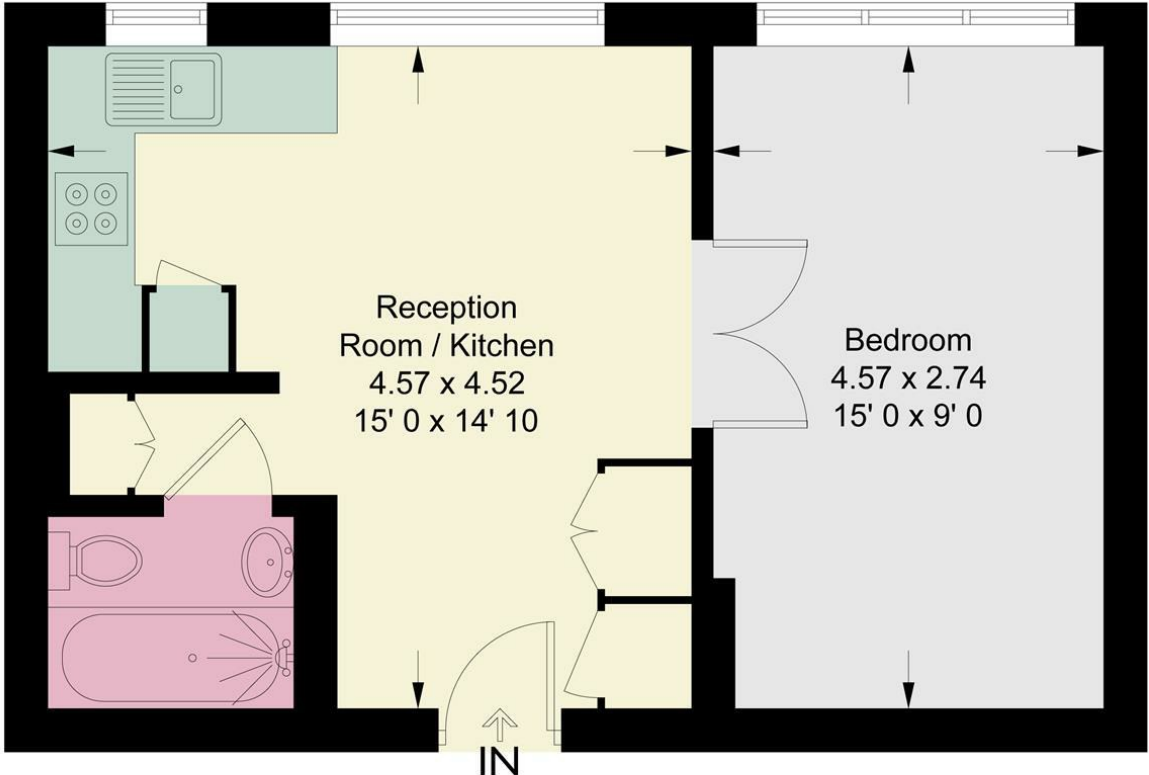

Ground Floor

This plan is not to scale and must be used as layout guidance only. All measurements and areas are approximate and should not be relied upon to provide accurate information. This plan must not be relied upon when making property valuations, design considerations or any other such relevant decisions. We accept no responsibility or liability (whether in contract, tort or otherwise) in relation to any loss whatsoever arising from or in connection with any use of this plan or the adequacy, accuracy or completeness of it or any information within it.



Energy Efficiency Rating		
	Current	Potential
Very energy efficient - lower running costs		
(92 plus) A		
(81-91) B		
(69-80) C		
(55-68) D		
(39-54) E		
(21-38) F		
(1-20) G		
Not energy efficient - higher running costs		
	72	76
England & Wales	EU Directive 2002/91/EC	

Environmental Impact (CO <sub>2</sub> ) Rating		
	Current	Potential
Very environmentally friendly - lower CO <sub>2</sub> emissions		
(92 plus) A		
(81-91) B		
(69-80) C		
(55-68) D		
(39-54) E		
(21-38) F		
(1-20) G		
Not environmentally friendly - higher CO <sub>2</sub> emissions		
England & Wales	EU Directive 2002/91/EC	

