



JAMES
ANDERSON

Medfield Street
London SW15
Guide Price £1,350,000



Medfield Street London SW15

Set within an exclusive leafy conservation enclave and rarely brought to market, this exquisite red-brick Gothic family residence exudes timeless elegance and refined charm. Interior-designed and beautifully presented, the home offers expansive and versatile living space arranged gracefully over three floors.

Enjoying a privileged position with uninterrupted views over the historic Putney Heath, the property delivers a rare blend of country-style serenity with the convenience of city living.

Internally, the home offers an exceptional layout for both family life and entertaining. The ground level provides a bright and elegant reception room alongside a studio/bedroom, while the lower ground floor boasts a spacious bedroom with its own private entrance, ideal for guests or multi-generational living. The sleek, contemporary kitchen and dining area are bathed in natural light and open directly onto the beautifully landscaped and perfectly maintained garden, creating a seamless indoor-outdoor experience. The property also benefits from a well-equipped utility room and a stylish shower room.

Upstairs, an additional generously sized bedroom is complemented by a luxurious four-piece family bathroom suite. The home benefits from abundant natural light throughout, original period features, and thoughtfully curated design details that blend heritage charm with modern comfort.

Roehampton Village, offers a warm, close-knit community and a rich historical backdrop. Nestled directly on Putney Heath, it's a mere six-minute stroll across the Heath to Wimbledon Common, and just ten minutes to the renowned Richmond Park and Barnes Common. The location provides unrivalled access to London's finest open green spaces, abundant with wildlife and walking trails.

Ideally positioned with seamless access to Barnes, Putney, and Wimbledon Village, and enhanced by excellent transport connections, this presents a rare opportunity to acquire residence of such distinction and quality.



















JAMES
ANDERSON

Medfield Street

Approximate Gross Internal Area = 1330 sq ft / 123.6 sq m



JAMES
ANDERSON

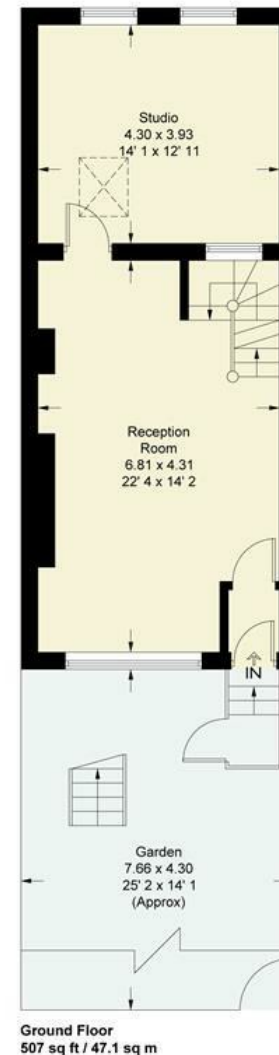
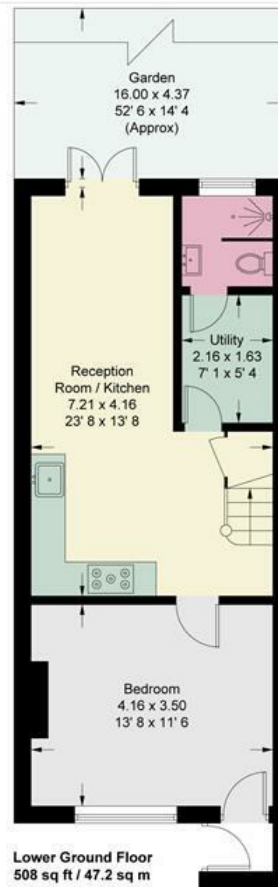

78 Lower Richmond Road
Putney
SW15 1LL

020 8788 6611
sales@japutney.co.uk
www.jamesanderson.co.uk

This plan is not to scale and must be used as layout guidance only. All measurements and areas are approximate and should not be relied upon to provide accurate information. This plan must not be relied upon when making property valuations, design considerations or any other such relevant decisions. We accept no responsibility or liability (whether in contract, tort or otherwise) in relation to any loss whatsoever arising from or in connection with any use of this plan or the adequacy, accuracy or completeness of it or any information within it.

