



JAMES
ANDERSON

Worple Street
Mortlake SW14
£850,000



Worple Street Mortlake SW14

A beautiful remodelled Victorian terrace cottage, stylishly combining period charm with contemporary design. This exceptional home has been thoughtfully and sympathetically upgraded throughout, placing a strong emphasis on natural light, quality finishes and ample storage. The result is a light filled, warm and characterful space that feels both elegant and inviting. The ground floor has been extended and reconfigured to create a bright, open-plan living area with attractive wooden flooring creating a seamless sense of flow. The bespoke shaker-style kitchen, featuring handmade cabinetry, stone worktops, a large built-in larder cupboard, and a discreet utility space housing a washing machine and dryer.

Other features include a newly added contemporary ground floor WC, built-in spacious coat cupboard in the entrance area, and solid wood sash windows installed in accordance with Conservation Area guidelines.

A welcoming double reception room with sash windows and a feature fireplace leads into the beautifully appointed kitchen, French doors open onto the paved courtyard garden. This private outdoor space acts as a natural extension of the living area, ideal for entertaining.

Upstairs, the generous principal bedroom features a sash window and fitted wardrobes, complemented by a good-sized second bedroom and a stylish family bathroom. A large, fully boarded loft provides excellent storage, with integral loft ladder accessible from the landing.

Worple Street is a highly sought after and attractive 'no through' road, known for its quiet, neighbourly atmosphere and easy on-street parking. The road is ideally situated, with the Thames River towpath moments away, Richmond Park, Kew Gardens and various sports clubs. Mortlake station is a couple of minutes walk and there are a number of local primary schools currently rated by Ofsted as 'Outstanding'. Local shops, eateries and amenities can be found on White Hart Lane, Barnes Village and East Sheen.

















Worple Street

Approximate Gross Internal Area = 946 sq ft / 87.9 sq m
(Including Reduced Headroom)

Reduced Headroom = 223 sq ft / 20.7 sq m



JAMES
ANDERSON



Ground Floor
430 sq ft / 40 sq m

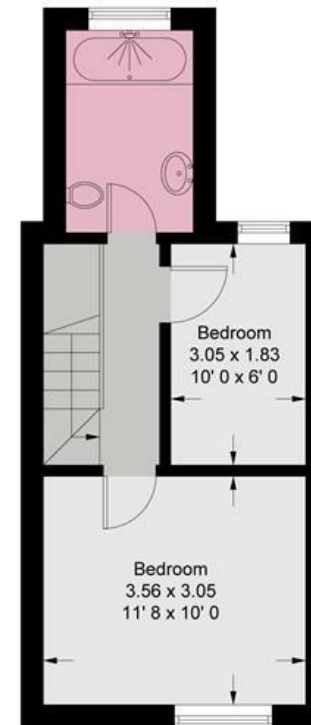

First Floor
293 sq ft / 27.2 sq m

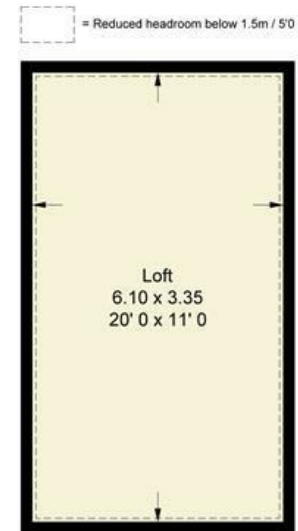

Loft
223 sq ft / 20.7 sq m
(Including Reduced Headroom)



JAMES
ANDERSON

This plan is not to scale and must be used as layout guidance only. All measurements and areas are approximate and should not be relied upon to provide accurate information. This plan must not be relied upon when making property valuations, design considerations or any other such relevant decisions. We accept no responsibility or liability (whether in contract, tort or otherwise) in relation to any loss whatsoever arising from or in connection with any use of this plan or the adequacy, accuracy or completeness of it or any information within it.





64 Barnes High Street
Barnes
SW13 9LD

020 8876 0100
sales@jabarnes.co.uk
www.jamesanderson.co.uk

