



JAMES  
ANDERSON

Pentlow Street  
Putney SW15  
Guide Price £450,000





## Pentlow Street Putney SW15

Located on one of West Putney's most sought-after residential roads, this charming period apartment offers a rare combination of character, comfort, and convenience, ideal for those looking to enjoy everything this vibrant and well-connected neighbourhood has to offer.

Set within a handsome building full of period charm, the apartment boasts well-proportioned rooms and an abundance of natural light throughout. At the heart of the home is a bright and inviting reception room with ample space to dine, perfect for entertaining or unwinding after a long day. A private terrace to the rear offers a peaceful retreat, overlooking beautifully maintained communal gardens — a rare find in such a central location.

The accommodation further comprises a spacious double bedroom complete with built-in wardrobes, a stylish fitted kitchen with contemporary units and integrated appliances, and a modern bathroom with a wash hand basin, alongside a separate WC for added convenience. Original features such as high ceilings and sash windows add to the apartment's timeless appeal.

West Putney is renowned for its leafy streets, period architecture, and strong sense of community. This particular road is especially desirable due to its quiet, residential character while remaining just a short walk from the amenities of the Lower Richmond Road and Putney High Street. The area is home to a wide array of independent cafés, restaurants, and boutiques, as well as excellent local pubs and green spaces such as Putney Common and the riverside walks along the Thames.

For commuters, the property is ideally located within easy reach of both Putney mainline station (offering direct services to London Waterloo) and East Putney Underground Station (District Line), making access to Central London fast and convenient. Numerous bus routes also serve the area, and the nearby A3 provides quick access out of London towards Surrey and beyond.

Tenure - Leasehold - 986 Years





































JAMES  
ANDERSON



## Pentlow Street

Approximate Gross Internal Area = 412 sq ft / 38.3 sq m



JAMES  
ANDERSON



78 Lower Richmond Road  
Putney  
SW15 1LL

020 8788 6611  
sales@japutney.co.uk  
www.jamesanderson.co.uk

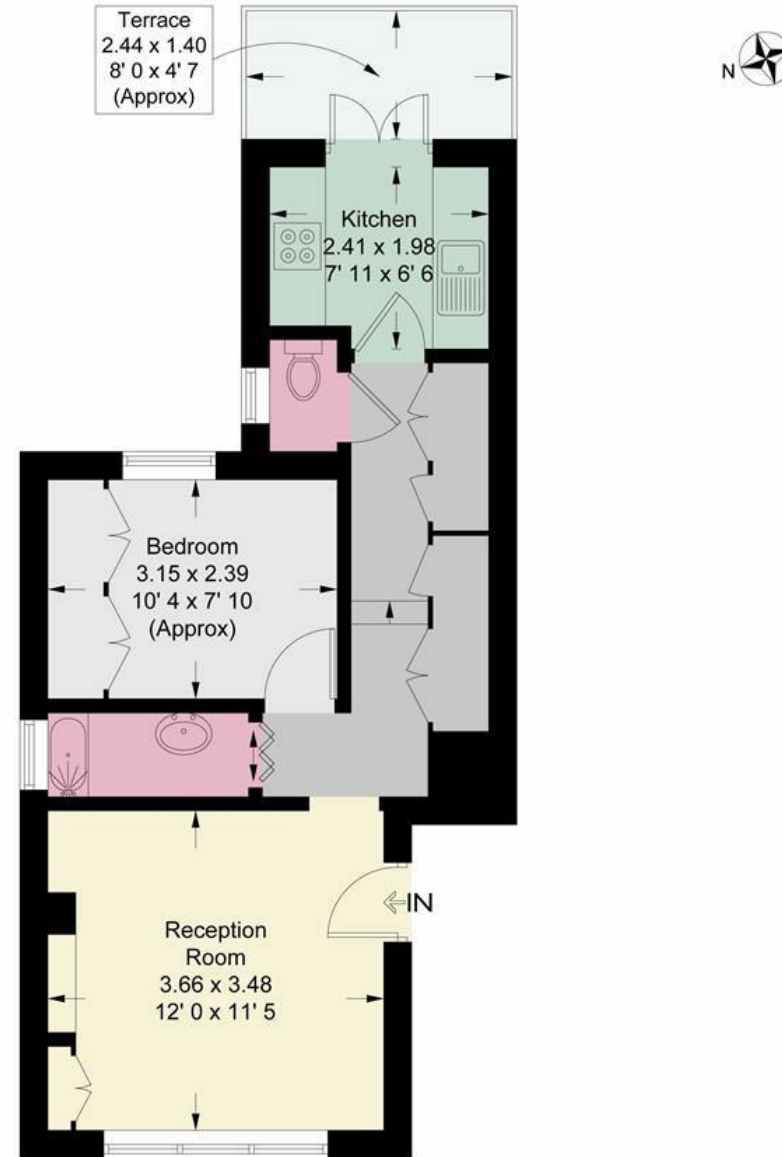

**Raised Ground Floor**

This plan is not to scale and must be used as layout guidance only. All measurements and areas are approximate and should not be relied upon to provide accurate information. This plan must not be relied upon when making property valuations, design considerations or any other such relevant decisions. We accept no responsibility or liability (whether in contract, tort or otherwise) in relation to any loss whatsoever arising from or in connection with any use of this plan or the adequacy, accuracy or completeness of it or any information within it.

