



JAMES
ANDERSON



TO LET

Cowley Mansions, Mortlake, SW14

£2,200 Per Month

Per Month

This three bedroom flat is on the top floor of Cowley Mansions and benefits from ample space. The property comprises a large living room with plenty of natural light, fully fitted eat in kitchen, three good sized bedrooms and a family bathroom. Tenants also have access to a shared garden. It is located within a five minute walk of local shops on White Hart Lane and Barnes Bridge Station. This is perfect for a family looking to settle down in a home long term and comes unfurnished.



Three Bedrooms



Modern Bathroom



Spacious Reception



Eat in Kitchen



EPC E | Council Tax E | Deposit £2,538.46



Barnes Bridge Station



Barnes Primary School



Easy Access to Hammersmith



Access to Shared Garden



12 Month Minimum | Holding Deposit £507.69



OPEN 7 DAYS A WEEK • Weekdays until 9pm • Weekends until 5pm

0208 878 8688

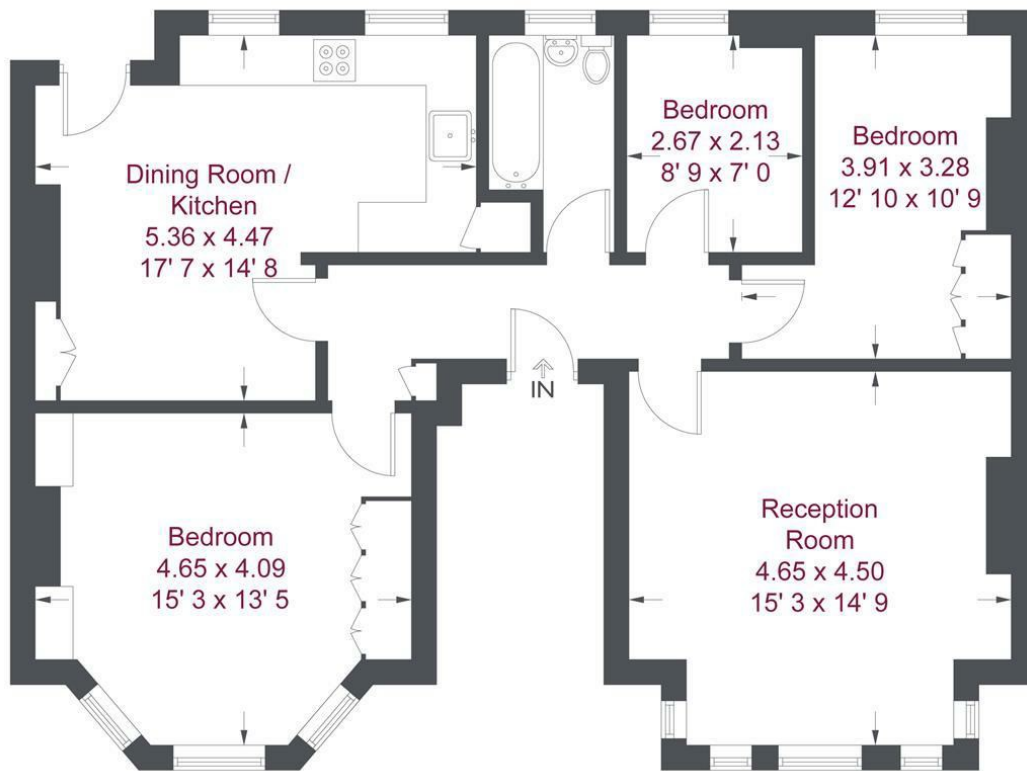

Second Floor

Cowley Mansions

Approximate Gross Internal Area = 924 sq ft / 85.8 sq m

Not to scale, for guidance only and must not be relied upon as a statement of fact
All measurements and areas are approximate only and have been prepared in
accordance with the current edition of the RICS Code of Measuring Practice

Energy Efficiency Rating		
	Current	Potential
Very energy efficient - lower running costs		
(92 plus) A		
(81-91) B		
(69-80) C		
(55-68) D		
(39-54) E		
(21-38) F		
(1-20) G		
Not energy efficient - higher running costs		
	53	78
England & Wales	EU Directive 2002/91/EC 	

Environmental Impact (CO ₂) Rating		
	Current	Potential
Very environmentally friendly - lower CO ₂ emissions		
(92 plus) A		
(81-91) B		
(69-80) C		
(55-68) D		
(39-54) E		
(21-38) F		
(1-20) G		
Not environmentally friendly - higher CO ₂ emissions		
England & Wales	EU Directive 2002/91/EC 