



**JAMES
ANDERSON**

South Worple Way
London SW14
£935,000



South Worple Way London SW14

This wonderful home perfectly combines high-end modern design with charm and character. There is also existing planning in place to convert the loft, adding two further bedrooms and another bathroom (Ref: 21/2359/PS192). The house features a newly extended kitchen, courtyard garden, plantation window shutters, cast iron radiators, underfloor heating, hot tap, new boiler, acoustic glass triple glazed sash windows, high ceilings and restored fireplaces throughout. The new London door Company pink frontdoor with brass fittings leads onto a Victorian style mosaic tiled hallway with original coving features. The ground floor living space comprises hallway with understairs toilet/ cloakroom, bay fronted lounge with fireplace, a sensational open plan kitchen/dining room with quartz central island and bifold doors perfectly framing the lovely garden. Stairs lead to the first floor offering landing, contemporary refitted bathroom with freestanding stone bath and Lusso stone fittings, a double bedroom, bay fronted principal bedroom with built in wardrobes and ensuite shower room. There is a large loft for storage and future development. Externally there is an attractive front garden with Victorian style mosaic tiled path and the addition of a cedar clad garden home office with heating, electrics and lighting as well as storage and useful rear alleyway access. South Worple Way is conveniently located with easy access to White Hart Lane, and it's local shops and gastro pubs, restaurants and coffee shops together with bus routes giving access to neighbouring towns. Mortlake and Barnes Bridge mainline station is within walking distance and both Barnes and East Sheen town centres are easily accessible. The property is also within the catchment area of Thompson House School.















what we love

'The courtyard garden captures summer and winter sun and is a haven of quiet and peace in the hustle of East sheen! We love folding back the trifold doors, music playing and candles on, cooking for friends whilst they sit in the garden with a glass of wine'

- The Owners



South Worpole Way

Approximate Gross Internal Area = 948 sq ft / 88 sq m

Garden Room = 43 sq ft / 4 sq m

Store = 20 sq ft / 1.9 sq m

Total = 1011 sq ft / 93.9 sq m



JAMES
ANDERSON

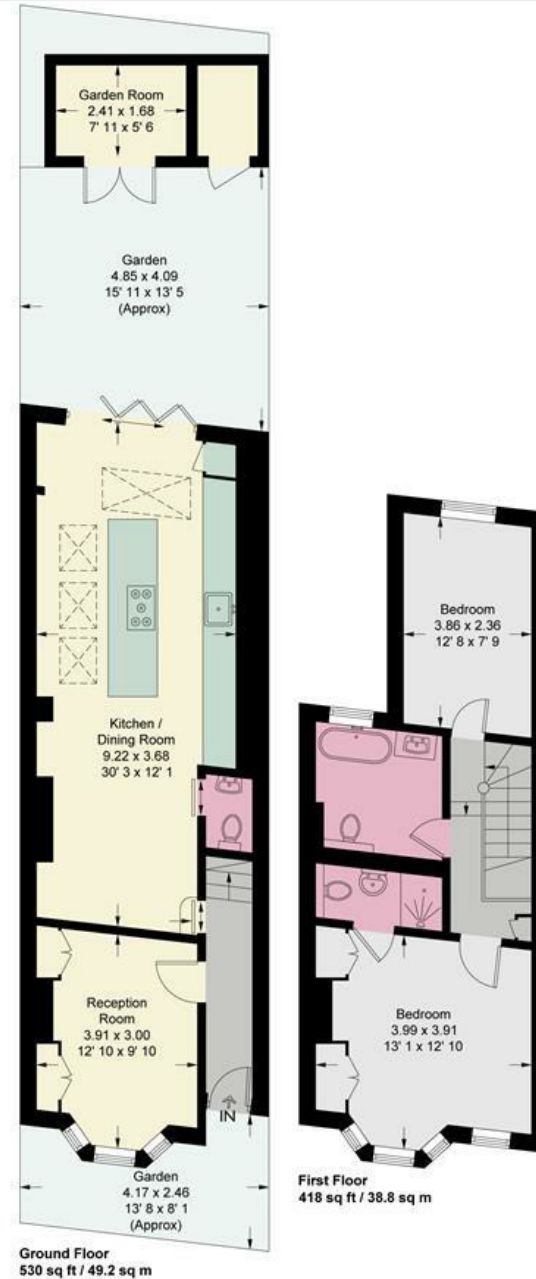

JAMES
ANDERSON

This plan is not to scale and must be used as layout guidance only. All measurements and areas are approximate and should not be relied upon to provide accurate information. This plan must not be relied upon when making property valuations, design considerations or any other such relevant decisions. We accept no responsibility or liability (whether in contract, tort or otherwise) in relation to any loss whatsoever arising from or in connection with any use of this plan or the adequacy, accuracy or completeness of it or any information within it.





363 Upper Richmond Road West
East Sheen
SW14 7NX

020 8876 6611
sales@jasheen.co.uk
www.jamesanderson.co.uk

