



JAMES
ANDERSON

Castelnau Gardens
Barnes SW13
£775,000



Castelnu Gardens Barnes SW13

A lovely garden apartment on the ground floor of an attractive mansion block in Barnes, close to Hammersmith Bridge. The property benefits from plenty of natural light and its own private garden. The property comprises a generous hall, two large double bedrooms (one of which has French doors to the garden), a spacious bay-fronted reception room, separate fully fitted kitchen/dining room and a main family bathroom.

Castelnu Gardens is located in North Barnes, close to Hammersmith Bridge and the river Thames. Local shops and amenities are at the top of the road with local bus services to Barnes, Putney, Richmond and into London. Barnes village is a short bus ride or walk. The village offers a selection of shops, cafes, pubs, restaurants, cinema and duck pond. There are some excellent schools in the area, including renowned St Paul's Boys & Juniors, The Harrodian and The Swedish School. Rail links are conveniently situated at Barnes mainline station, providing regular services to London Waterloo. This property is available for sale with no onward chain.

Leasehold
162 Years Remaining
Service Charges = £3,813 per annum.
No ground rent









White kitchen cabinets on the left side, including a tall refrigerator and lower cabinets with silver handles.

A white front-loading washing machine integrated into the kitchen cabinetry under the window.

Two large windows with white frames, providing a view of lush green trees and foliage.

White kitchen cabinets with glass-paned doors, mounted above the countertop and featuring a corner shelf.

Two white wooden chairs with a cross-back design and floral patterned seat cushions, positioned at the dining table.

A long white shelf mounted on the wall above the dining table, holding a round analog clock, a small white electronic device, and a green ceramic teapot.

A white dining table with a thick wooden top and a white bench underneath, situated in the dining area.

A light-colored, textured rug placed on the floor in the dining area.

A modern ceiling light fixture with three adjustable spotlights.

A colorful mosaic tile backsplash in shades of brown, tan, and blue, located behind the kitchen counter.









Castelnau Gardens

Approximate Gross Internal Area = 880 sq ft / 81.8 sq m



JAMES
ANDERSON

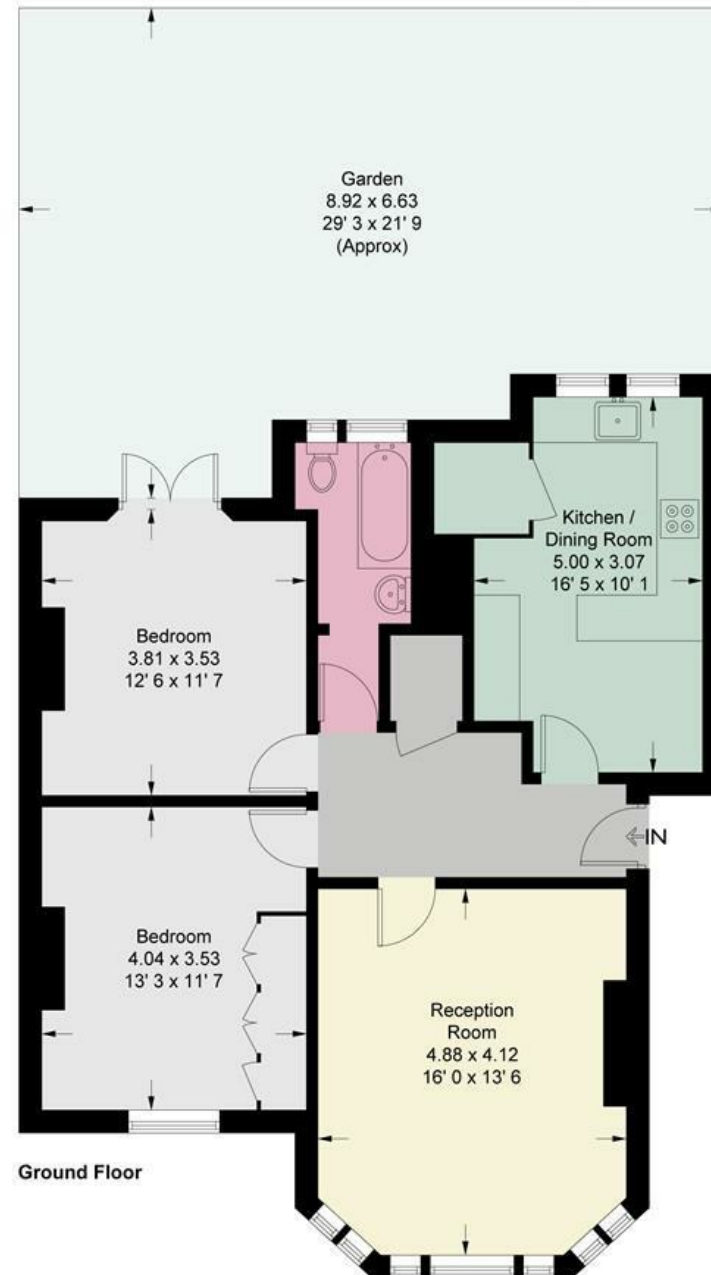

JAMES
ANDERSON

This plan is not to scale and must be used as layout guidance only. All measurements and areas are approximate and should not be relied upon to provide accurate information. This plan must not be relied upon when making property valuations, design considerations or any other such relevant decisions. We accept no responsibility or liability (whether in contract, tort or otherwise) in relation to any loss whatsoever arising from or in connection with any use of this plan or the adequacy, accuracy or completeness of it or any information within it.





64 Barnes High Street
Barnes
SW13 9LD

020 8876 0100
sales@jabarnes.co.uk
www.jamesanderson.co.uk

