



**JAMES  
ANDERSON**



## TO LET

Cressy House, Putney, SW13

## £2,100 Per Month

Per Month

A well presented two double bedroom apartment situated in a fantastic location and within easy reach of Barnes BR station, local shops, transport links and conveniently located for Putney town centre and Barnes Village. The property comprises bright and spacious lounge/ diner, fitted kitchen, two double bedrooms, modern bathroom with over bath shower and additional shower room with WC. This property further benefits from double glazing throughout, gas central heating, one Resident's Parking space and communal gardens.



Two Double Bedrooms



Two Bathrooms



Spacious Reception



Modern Kitchen



EPC D / Council Tax D / Deposit £2,423.07



Barnes Train Station



Roehampton University



Close to Putney Common



Furnished



12 Month Minimum Term / Holding Deposit £484.61



OPEN 7 DAYS A WEEK • Weekdays until 9pm • Weekends until 5pm

0208 785 4400

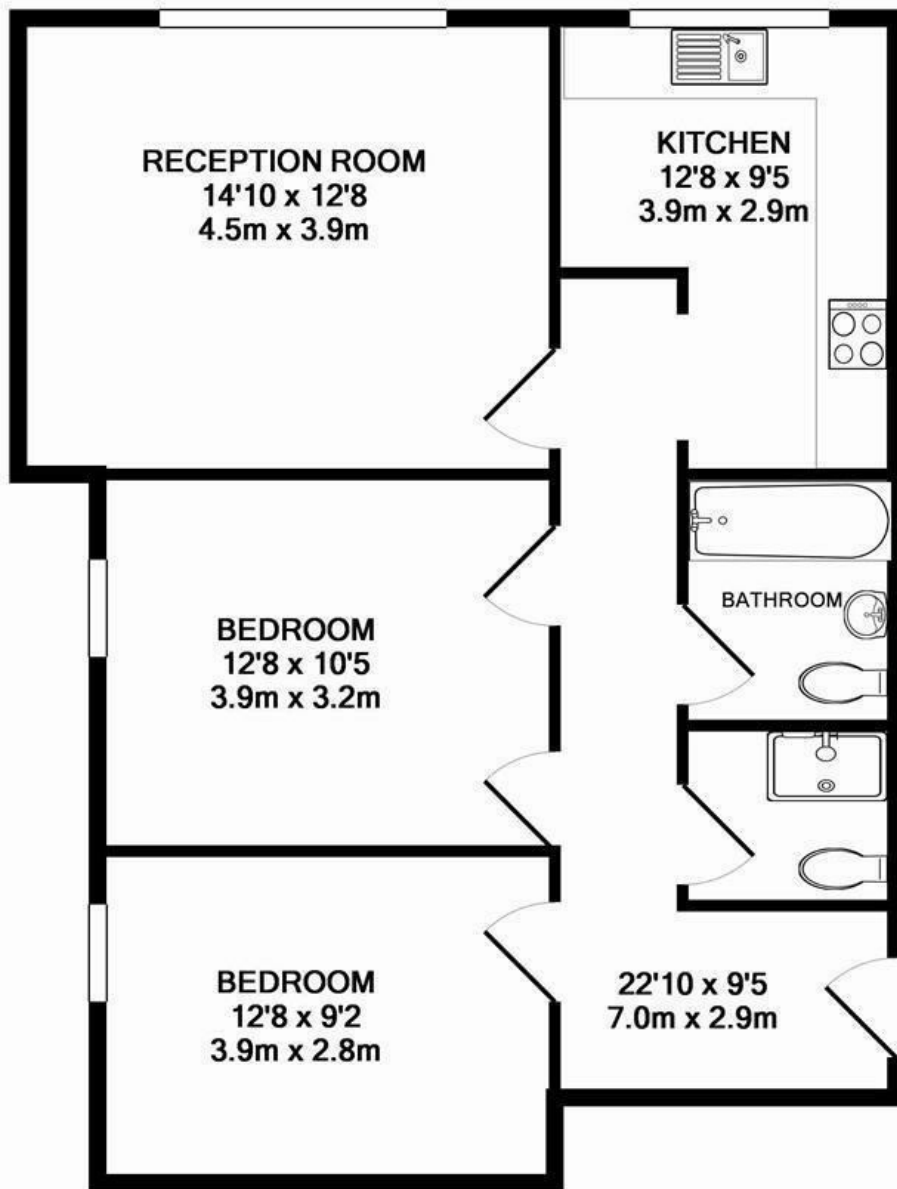

**CRESSY HOUSE**  
TOTAL APPROX. FLOOR AREA 719 SQ.FT. (66.8 SQ.M.)

Whilst every attempt has been made to ensure the accuracy of the floor plan contained here, measurements of doors, windows, rooms and any other items are approximate and no responsibility is taken for any error, omission, or mis-statement. This plan is for illustrative purposes only and should be used as such by any prospective purchaser. The services, systems and appliances shown have not been tested and no guarantee as to their operability or efficiency can be given

Made with Metropix ©2014

