



**JAMES  
ANDERSON**



## TO LET

Deanhill Court, East Sheen, SW14

## £1,860 Per Month

Per Month

A fantastic two-bedroom apartment with a private garage. This first floor flat offers a modern tiled bathroom with shower over bath, a spacious living room, a fully fitted contemporary kitchen and two double bedrooms. Furthermore, the apartment has full use of a private garage. Deanhill Court is enviably situated with a number of supermarkets, cafes and restaurants on your doorstep. Sheen Mount School is walking distance and Richmond Park, Sheen Common and the River Thames and all nearby. For the commuter, Mortlake station is a short walk, providing transport links into central London within 23 minutes.



Two Double Bedrooms



Modern Bathroom



Unfurnished



Fully Fitted Kitchen



EPC C | Council Tax D | Minimum Term 12 Months



Mortlake Station



Sheen Mount Primary School



Close to Local Shops



Private Garage



Holding Deposit £461.53 | Deposit Required £2307.69



OPEN 7 DAYS A WEEK • Weekdays until 9pm • Weekends until 5pm

0208 876 6611

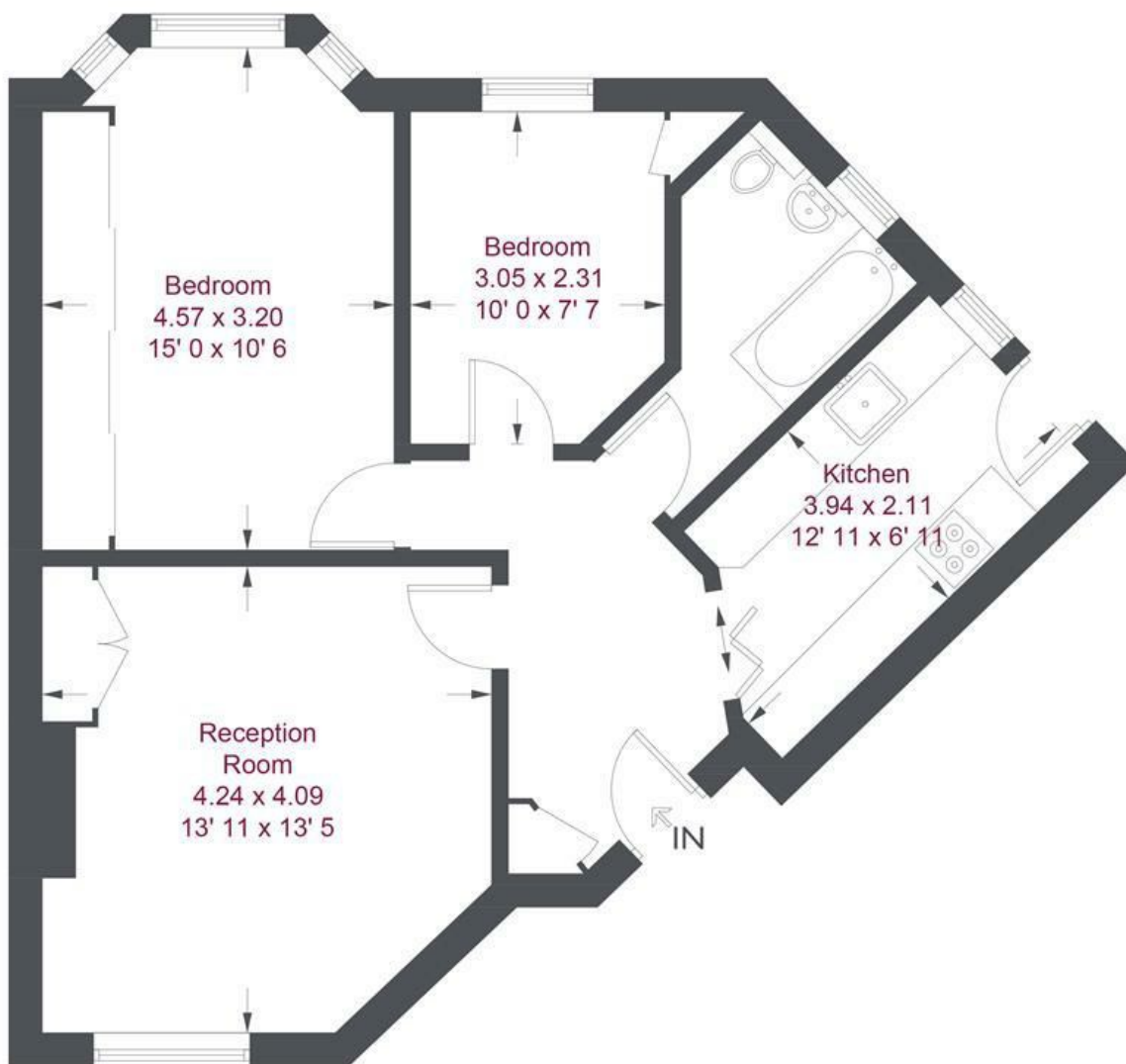

**First Floor**

### Deanhill Court

Approximate Gross Internal Area = 640 sq ft / 59.5 sq m

Not to scale, for guidance only and must not be relied upon as a statement of fact  
 All measurements and areas are approximate only and have been prepared in accordance with the current edition of the RICS Code of Measuring Practice

Energy Efficiency Rating		Current	Potential
Very energy efficient - lower running costs			
(92 plus) <b>A</b>			
(81-91) <b>B</b>			
(69-80) <b>C</b>		<b>74</b>	<b>74</b>
(55-68) <b>D</b>			
(39-54) <b>E</b>			
(21-38) <b>F</b>			
(1-20) <b>G</b>			
Not energy efficient - higher running costs			
<b>England &amp; Wales</b>	EU Directive 2002/91/EC		

Environmental Impact (CO <sub>2</sub> ) Rating		Current	Potential
Very environmentally friendly - lower CO <sub>2</sub> emissions			
(92 plus) <b>A</b>			
(81-91) <b>B</b>			
(69-80) <b>C</b>			
(55-68) <b>D</b>			
(39-54) <b>E</b>			
(21-38) <b>F</b>			
(1-20) <b>G</b>			
Not environmentally friendly - higher CO <sub>2</sub> emissions			
<b>England &amp; Wales</b>	EU Directive 2002/91/EC		

