



**JAMES
ANDERSON**



TO LET

Dovecote Gardens, Mortlake, SW14

£1,450 Per Month

Per Month

A bright and extremely spacious one bedroom apartment in a quiet and well maintained development. The apartment boasts an extremely generous living room, a fully fitted bathroom and modern kitchen along with a spacious double bedroom with fitted mirrored wardrobes. There is also ample storage throughout the apartment including a loft space, additionally the property is fully double glazed and benefits from allocated off street parking and bicycle storage. Dovecote Gardens is a short walk to both Mortlake and Barnes Bridge Stations as well as the River Thames and the shops and cafes on White Hart Lane.



One Bedroom Apartment



Modern Bathroom



Spacious Reception Room



Fitted Kitchen



EPC C/ Council Tax D/ Deposit £1,673.07



Mortlake Station



Outstanding Local Schools



River Thames



Off Street Parking



Holding Deposit £334.61



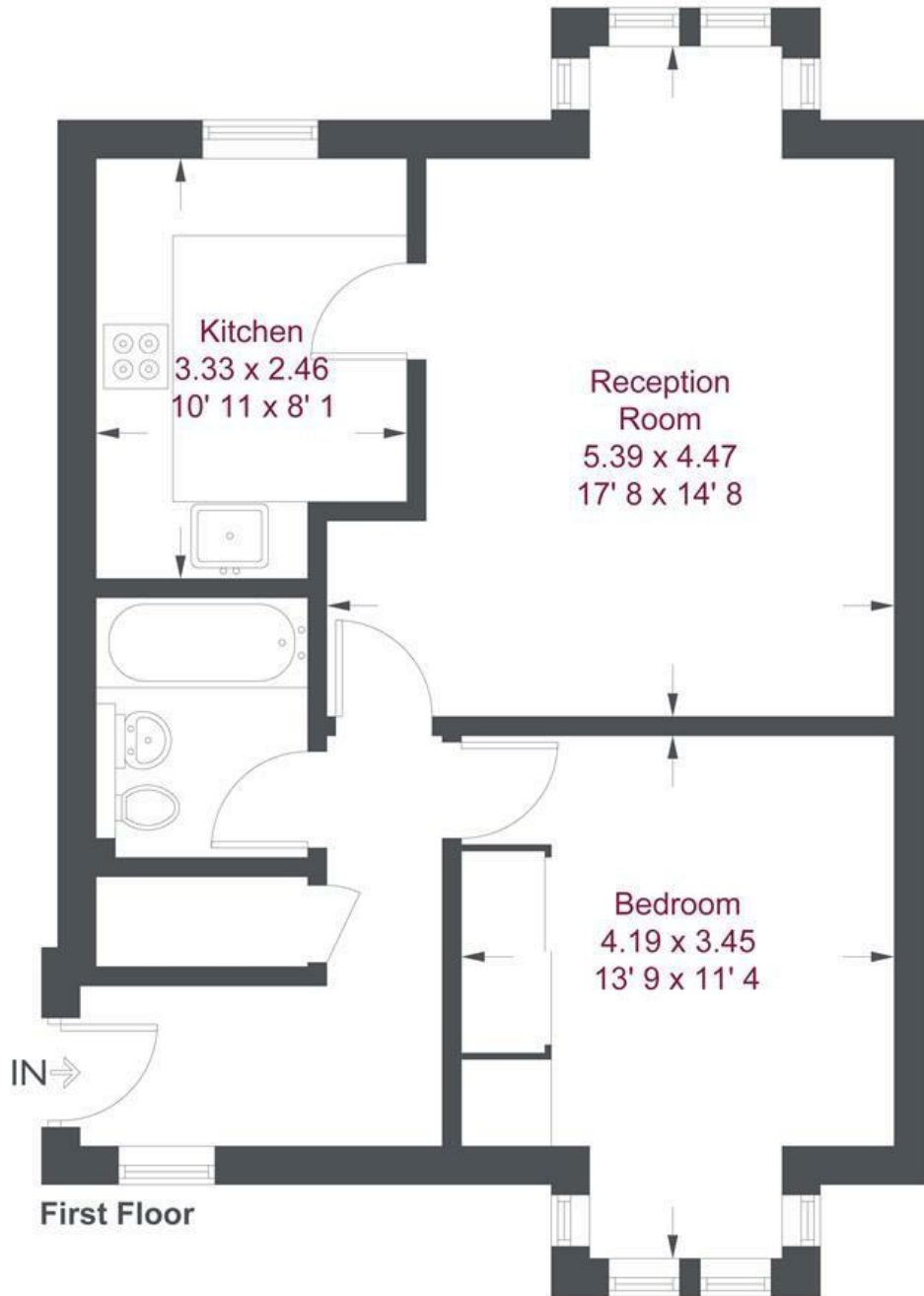

Dovecote Gardens

Approximate Gross Internal Area = 565 sq ft / 52.5 sq m

Not to scale, for guidance only and must not be relied upon as a statement of fact
 All measurements and areas are approximate only and have been prepared in accordance with the current edition of the RICS Code of Measuring Practice

Energy Efficiency Rating		
	Current	Potential
<i>Very energy efficient - lower running costs</i>		
(92 plus) A		
(81-91) B		
(69-80) C	77	77
(55-68) D		
(39-54) E		
(21-38) F		
(1-20) G		
<i>Not energy efficient - higher running costs</i>		
England & Wales	EU Directive 2002/91/EC	

Environmental Impact (CO ₂) Rating		
	Current	Potential
<i>Very environmentally friendly - lower CO₂ emissions</i>		
(92 plus) A		
(81-91) B		
(69-80) C		
(55-68) D		
(39-54) E		
(21-38) F		
(1-20) G		
<i>Not environmentally friendly - higher CO₂ emissions</i>		
England & Wales	EU Directive 2002/91/EC	

